

S. 250

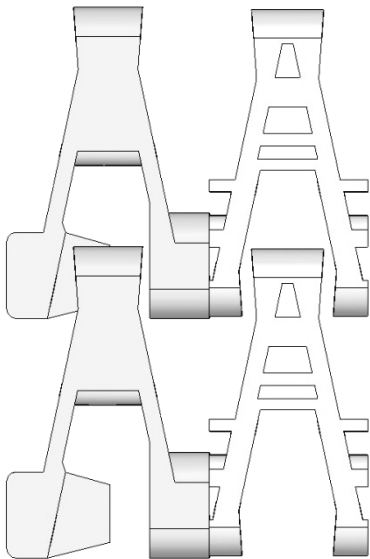

Belt data		
Materials	Max. belt pull kg	Belt weight kg/m ²
Polyacetal (POM)	250	9
Polypropylene (PP)	140	7,5

Belt surface: Smooth.
Open area: 67 %
Strength: The right belt for heavy transportation.
Material/colour: POM, PP
Cleanability: Good
Accessories: 3 mm flight buds made in friction material or POM/PP. 25 mm side guards. Steel reinforcements.
Application: Spiral coolers, radius conveyors.
Construction: 43 mm side modules, 200 mm centre modules.
Width interval: Normally 33 mm. E.g: 119 mm, 152 mm etc.
 Contact Scanbelt.

Sprocket Data								
No. of teeth	A= Outside diameter	B= Pitch-diameter	C= Inside-diameter	Hub width:	Round bore		Square bore	
					mm	in.	mm	in.
11	186	174	162	22	30/40/45		40	
11 STEEL	186	174	162	22	FLEX			

