

S.50-610

Ideal for dairy, vegetables, poultry, snacks, sweets and other industries that handle products requiring drainage and small openings. FDA approved.

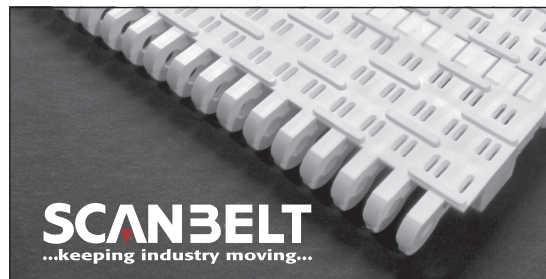

SCANBELT
...keeping industry moving...

SUGGESTED INDUSTRIES



STANDARD FEATURES

| | |
|----------------|--|
| Belt surface | Perforated flat top with 1 mm ribs |
| Open area | 9 %. Open area. Biggest opening 1,5 x 6 mm |
| Strength | Ideal choice for medium to heavy-duty transportation |
| Cleanability | Excellent. FSIS |
| Standard width | Increments of 10 mm, e.g. 100, 110 mm etc. |

BELT DATA

| Belt materials | Temperature range | | Max. belt pull kg/m of width | Belt weight kg/m ² | Belt weight kg/m ² w. steel rods | Standard Colours |
|----------------|-------------------|------|------------------------------|-------------------------------|---|------------------|
| | Min. | Max. | | | | |
| PE | - 73 | 66 | 1790 | 7 | 11 | Blue/Natural |
| PP | + 5 | 100 | 2400 | 7 | 11 | Blue/White/Grey |
| POM | - 43 | 95 | 3600 | 11 | 15 | Blue/Natural |
| | | | | | | |

ACCESSORIES

| Type | mm |
|---------------------------------|---------------------|
| Flights | 25*, 50*, 75*, 100* |
| Scoop Flights | 50, 75, 100*, 150* |
| Bent Flights | 75*, 100* |
| Supported Flights | 75, 100, 150 |
| Flights fitted with a Round Top | Yes |
| Side Guard | 50, 75, 100, 150 |
| Friction Top | Yes |
| Hold-downs | Yes |

*Modules can be supplied with a moulded indent of 40 mm.

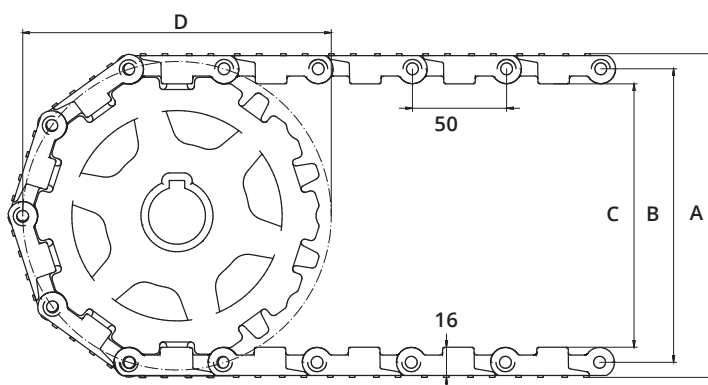

SPROCKET DATA

A = Outside, B = Pitch, C = Inside, D = Pitch Circle Diameter

| No. Teeth | A | B | C | D | Hub Width | Round Bore | | Square Bore | |
|-----------|-----|-----|-----|-----|-----------|------------------------|------------|-----------------------------|---------|
| | mm | mm | mm | mm | | mm | Inch | mm | Inch |
| 6 | 104 | 88 | 72 | 101 | 20 | 25 / 30 / 40 | ¾ / 1 / 1¼ | 25 / 40 | 1½ |
| 8 | 138 | 122 | 106 | 133 | 35 | 25 / 30 / 40 | 1 / 1¼ | 25 / 40 | 1½ |
| 10 | 172 | 156 | 140 | 164 | 35 | 25 / 30 / 40 | 1 / 1¼ | 20 / 25 / 40 / 60 / 50 / 60 | 1½ / 2½ |
| 12 | 205 | 189 | 173 | 195 | 35 | 25 / 30 / 40 / 50 / 60 | 1 / 1¼ | 25 / 40 / 60 / 80 | 1½ / 2½ |
| 16 | 270 | 254 | 238 | 258 | 35 | 60 / 80 | | 40 / 60 / 80 | |